

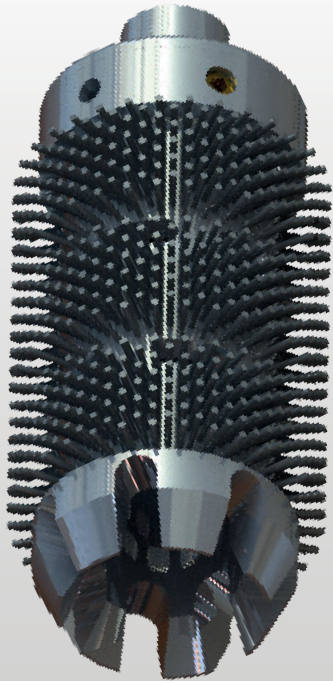

CX-DB (Drillable Brush)



Setting a bridge plug successfully requires a clean setting area. The CX-DB (Drillable Brush) is made up directly to the plug or packer to clean and effectively prepare tool setting areas. Fluid is directed through the body of the Drillable Brush to support cleaning.

Brushing can be done in the same run as the plug setting, eliminating the need for a dedicated scraper run and saving the additional run in-hole and more than three hours in rig time. This also creates a better cement bond, reducing the risk of micro annuli and increasing reliability.

BENEFITS

- Available in sizes from 4 1/2" through to 20"
- Drillable alloy body
- Can be attached to any drillable tools on drill pipe or tubing
- Swivel connector with optional 'torque free' or 'locked' configuration



SPECIFICATIONS

Casing Size	Casing Weights Covered	Tool Overall Length	Bristled OD	Hard OD	Upper Connection
4 1/2"	10.5# - 17.1#	21.000"	4.125"	3.250"	2-3/8" EUE PIN
	18.8# - 21.6#	17.400"	3.750"	3.000"	2-3/8" PAC PIN
5"	11.5# - 15#	20.900"	5.400"	4.100"	2-7/8" EUE PIN
	18# - 24.1#	17.400"	4.400"	3.500"	2-3/8" PAC PIN
6 5/8"	20# - 35#	21.000"	6.300"	5.000"	2-7/8" EUE PIN
7"	17# - 35#	21.000"	6.754"	5.500"	2-7/8" EUE PIN
8 5/8"	24# - 63.5#	20.900"	8.375"	6.500"	2-7/8" EUE PIN
9 5/8"	32.3# - 64.9#	21.000"	9.250"	7.700"	2-7/8" EUE PIN
	ALL CASING SIZES	21.000"	9.250"	6.500"	2-7/8" EUE PIN
10 3/4"	40.5# - 79.2#	25.250"	10.200"	8.760"	2-7/8" EUE PIN
11 3/4"	42# - 60#	21.000"	11.380"	10.250"	2-7/8" EUE PIN
13 3/8"	ALL CASING SIZES	19.250"	13.000"	11.250"	2-7/8" EUE PIN
16"	95# - 97#	20.900"	15.125"	14.250"	2-7/8" EUE PIN
20"	94# - 187#	22.250"	19.250"	16.500"	3-1/2" EUE PIN