

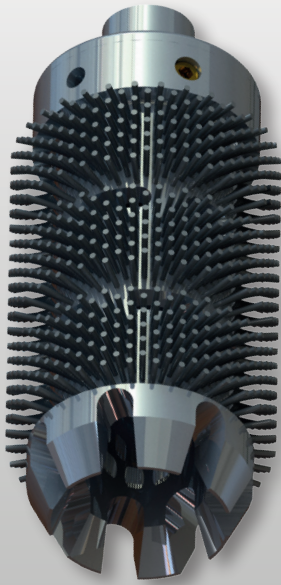

# CX-DB



Setting a bridge plug successfully requires a clean setting area. The CX-DB (Drillable Brush) is made up directly to the plug or packer to clean and effectively prepare tool setting areas. Fluid is directed through the body of the Drillable Brush to support cleaning.

Brushing can be done in the same run as the plug setting, eliminating the need for a dedicated scraper run and saving the additional run in-hole and more than three hours in rig time. This also creates a better cement bond, reducing the risk of micro annuli and increasing reliability.

## BENEFITS

- Available in sizes from 4½" through to 20"
- Drillable alloy body
- Can be attached to any drillable tools on drill pipe or tubing
- Swivel connector with optional 'torque free' or 'locked' configuration

| Casing Size | Tool Overall Length | Bristled OD | Hard OD | Upper Connection |
|-------------|---------------------|-------------|---------|------------------|
| 4½"         | 21.000"             | 4.125"      | 3.250"  | 2¾" EUE Pin      |
| 7"          | 21.000"             | 6.754"      | 5.500"  | 2¾" EUE Pin      |
| 9⅝"         | 21.000"             | 9.250"      | 7.700"  | 2¾" EUE Pin      |
| 10¾"        | 25.250"             | 10.200"     | 8.760"  | 2¾" EUE Pin      |
| 11¾"        | 21.000"             | 11.380"     | 10.250" | 2¾" EUE Pin      |
| 13¾"        | 19.250"             | 13.000"     | 11.250" | 2¾" EUE Pin      |
| 20"         | 22.250"             | 19.250"     | 16.500" | 3½" EUE Pin      |

