

**EXPRO**

WELL FLOW MANAGEMENT™

# / Expro Excellence

## Well Testing & Production

Innovative well testing application delivers economical fast-track production solution



### Objectives/background

- Expro's customer was replacing its temporary platform (an existing drilling rig) with a newly fabricated platform to achieve a 12,000bbls/day and 6.5mmscf/day production objective
- Expro was approached to provide a fast-track solution for delivering production facilities – leveraging existing contractual arrangements
- A solution was required which was flexible, cost effective and allowed the client to significantly accelerate their production delivery

### Expro Excellence

- Expro designed a bespoke solution that modified existing well test assets to form the basis of a production system including; Separators, process heaters, tanks, pumps and flare booms
- This was designed and delivered and operated under a single existing contract allowing the customer to quickly monetise production from a marginal field
- A coordinated approach with both the client and their designated platform engineering company, ensured the

technical requirements were achieved and the interface perfectly aligned

- Production was continuously monitored and reported using Expro's web based real-time 'data to desk' transmission service. This allowed the client to optimise production rates further by monitoring well behaviours and flow rates, informing them on the best approach to bringing optimal wells into the production facility

### Value to client

- Expro's solution allowed the client to deliver the production nearly two years ahead of schedule when compared to a traditional EPIC (engineering, procurement, installation and commissioning) approach
- A dedicated project team with direct access to the 24-7 operations and maintenance support crew ensured the project was commissioned on schedule and with zero HSE incidents
- The project management team were aligned with both client and their other contractors to expedite the plan enabling the client to release the drilling rig per plan, successfully securing the project cost target

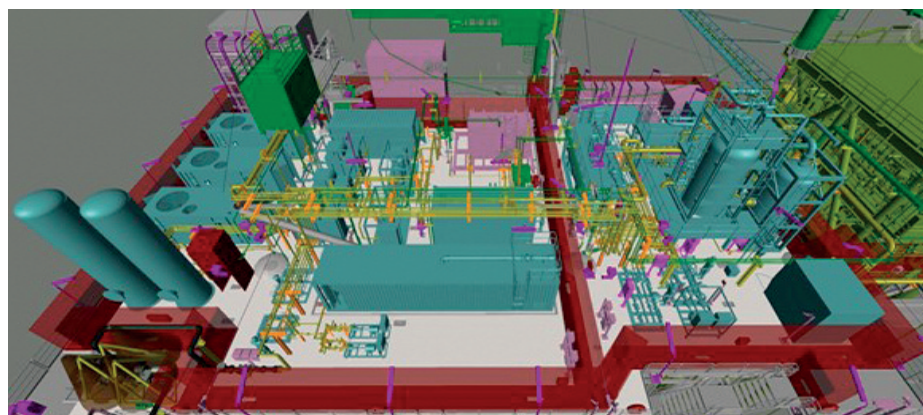

### Contact

For further information, please contact:

**[welltesting@exprogroup.com](mailto:welltesting@exprogroup.com)**

Or visit:

**[www.exprogroup.com/products-services/well-testing](http://www.exprogroup.com/products-services/well-testing)**

**Expro Excellence**[exprogroup.com](http://exprogroup.com)

## Well Testing & Production